

# Bronze Terminal Lugs - One Hole Tongue Type PNL

For use with one copper conductor

- Manufactured from high strength copper alloy for maximum conductivity and corrosion resistance
- Used for joining a wide range of copper conductors to equipment pads or bus bars
- Plated steel set screw provides high strength connection
- Annular serrations in conductor grooves of PNL-500 and PNL-1000 provide improved mechanical performance
- Flat bottoms allow for complete contact with mounting surface
- Inspection hole allows for visual confirmation of proper cable insertion
- Lug can be furnished electro-tin or silver plated
- For tin plating, suffix catalog number with “-TN”, “-SV” for silver plating

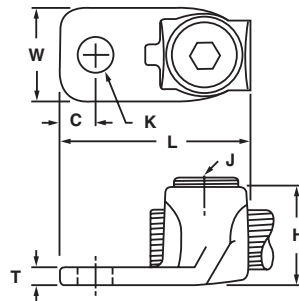

CATALOG NUMBER	CONDUCTOR RANGE	APPROXIMATE DIMENSIONS (IN.)							HEX SIZE
		C	K (DIA.)	H	L	T	W	J (SCREW THREAD)	
PNL-8	14 Sol. - 8 Str.	.19	.20	.44	.88	.09	.38	#12 - 24	Slot
PNL-4	14 Sol. - 4 Str.	.27	.27	.56	1.25	.14	.53	5/16 - 24	Slot
PNL-1/0	8 Sol. - 1/0 Str.	.38	.33	.78	1.59	.14	.73	1/2 - 20	1/4
PNL-250	6 Sol. - 250 kcmil	.44	.39	1.05	1.97	.13	.94	5/8 - 18	5/16
PNL-500	4 Sol. - 500 kcmil	.75	.53	1.47	3.00	.25	1.38	1 5/16 - 16	3/8
PNL-1000	500 - 1000 kcmil	.69	.56	2.00	3.88	.38	1.75	1 3/8 - 14	1/2

## Bronze Terminal Lugs - Two or Four Hole Tongue Type PNL

For use with one copper conductor

- Manufactured from high strength copper alloy for maximum conductivity and corrosion resistance
- Used for joining a wide range of copper conductors to equipment pads or bus bars
- Plated steel set screw provides high strength connection
- Two and four hole mounting pads allow for maximum surface contact in heavy duty applications
- Annular serrations in conductor grooves provide improved mechanical performance
- Inspection hole allows for visual confirmation of proper cable insertion
- Lug can be furnished electro-tin or silver plated
- For tin plating, suffix catalog number with “-TN”, “-SV” for silver plating

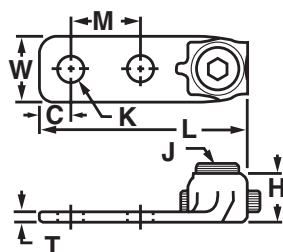

FIG. 1

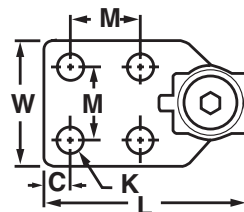

FIG. 2

CATALOG NUMBER	FIG. NO.	CONDUCTOR RANGE	APPROXIMATE DIMENSIONS (IN.)								HEX SIZE
			C	K (DIA.)	H	L	T	W	M	J (SCREW THREAD)	
PNL-1/0-2	1	8 Sol. - 1/0 Str.	.44	.34	.84	2.75	.19	.75	1.00	1/2 - 20	1/4
PNL-1/0-2N	1		.63	.56	.84	3.56	.19	1.00	1.75	1/2 - 20	1/4
PNL-250-2	1	6 Sol. - 250 kcmil	.44	.44	1.03	2.88	.22	.94	1.00	5/8 - 18	1/4
PNL-250-2N	1		.63	.56	1.13	4.25	.22	1.00	1.75	3/4 - 16	3/8
PNL-500-2	1	4 Sol. - 500 kcmil	.44	.44	1.47	3.38	.31	1.38	1.00	1 5/16 - 16	3/8
PNL-500-2N	1		.63	.56	1.47	4.38	.31	1.38	1.75	1 5/16 - 16	3/8
PNL-500-4N	2		.63	.56	1.47	4.38	.25	3.00	1.75	1 5/16 - 16	3/8
PNL-1000-2	1	500 - 1000 kcmil	.56	.56	2.00	4.88	.38	1.75	1.50	1 3/8 - 14	3/8
PNL-1000-2N	1		.53	.56	2.00	4.88	.38	1.94	1.75	1 3/8 - 14	3/8
PNL-1000-4N	2		.53	.56	2.00	4.88	.25	3.00	1.75	1 3/8 - 14	3/8

• CSA listed